

State of Wyoming Corner Record

(In compliance with the *CORNER PERPETUATION AND FILING ACT*, Wyoming Statutes, 1997 Section 33-29-140 et. seq., and the Rules and Regulations of the Board of Professional Engineers and Professional Land Surveyors)

Reverse side of this form may be used if more space is needed.

Record of original survey and citation of source of historical information (if corner is lost or obliterated). Description of corner monumentation evidence found and/or monument and accessories established to perpetuate the location of this corner. Sketch of relative location of monument, accessories, and reference points with course and distance to adjacent corner(s) (if determined in this survey). Method and rationale for re-establishment of lost or obliterated corner.

FOUND 5/8" REBAR 0.5' BELOW PAVEMENT
AND 10.8' SOUTH AND 13.0' NORTH EDGE OF
ROAD.

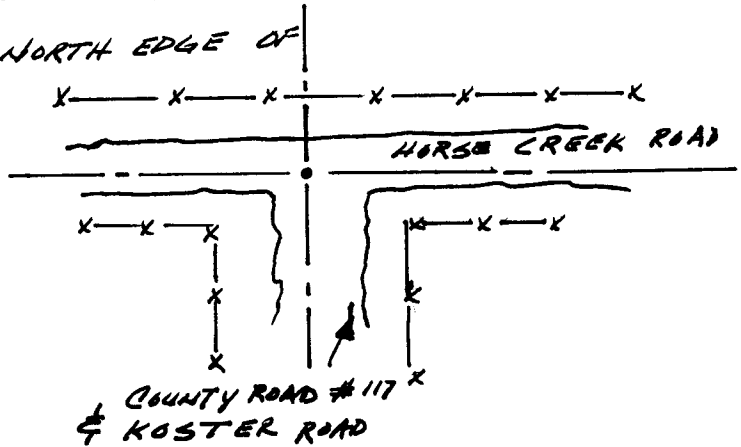

Project Coordinate: North 261860.55

Project Coordinate: East 71228.34

T14N 68W 6 PM
Monument location

RECORDED 7/13/1999 AT 11:42 AM REC# 256207 BK# 1527 PG# 80
DEBRA K. LATHROP, CLERK OF LARAMIE COUNTY, WY PAGE 1 OF 1

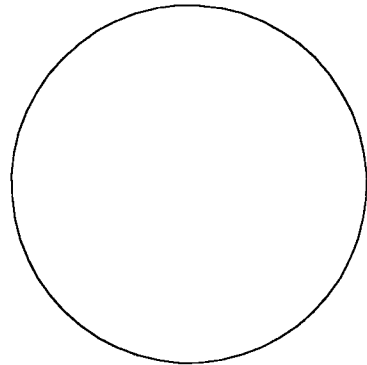
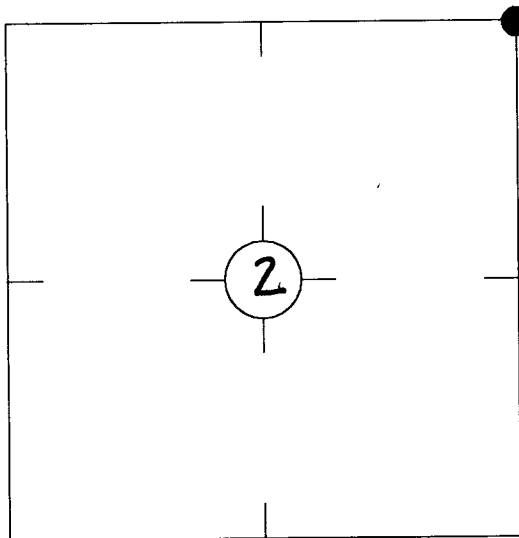

Monument Inscription

Date of Field Work: OCT. 23, 1998

Office Reference: IME 848RS PT 1858

Cross Index Plat

	1	2	3	4	5	6	7	8	9	10	11	12	13	14	15	16	17	18	19	20	21	22	23	24	25
A																									
B																									
C		6	5	4	3	2	1																		
D																									
E																									
F																									
G		7	8	9	10	11	12																		
H																									
J																									
K																									
L		18	17	16	15	14	13																		
M																									
N																									
O																									
P		19	20	21	22	23	24																		
Q																									
R																									
S																									
T		30	29	28	27	26	25																		
U																									
V																									
W																									
X		31	32	33	34	35	36																		
Y																									
Z																									
	1	2	3	4	5	6	7	8	9	10	11	12	13	14	15	16	17	18	19	20	21	22	23	24	25

Firm/Agency, Address

this corner record provided by:
**HAMILTON
LAND
SURVEYING**

102 West Ramahorn, Sta. 201
Dubois, WY: 307-455-2070
A WYOMING COMPANY PROVIDING:
COMMERCIAL - RESIDENTIAL - INDUSTRIAL
OIL & GAS - WATER RIGHTS - CONSTRUCTION
AND SUBDIVISION LAND SURVEYING SERVICES

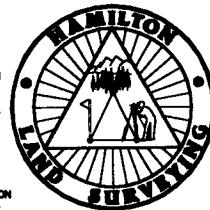

This corner record was prepared
by me or under my direction
and supervision.

SEAL & SIGNATURE

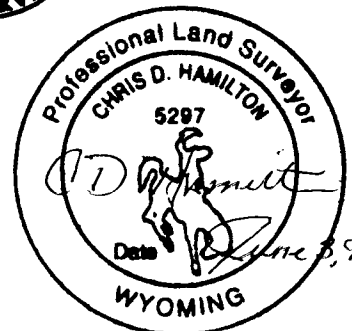

County: LARAMIE, Wyoming

Corner Name: NORTH EAST, Section: 2, T14N, R68W, 6 P.M., Cross-index No.: A-21